

Crimp-Rast-Stift-/Buchsenleisten gerade gewinkelt 1-/2-reihig RM 3,00mm

Technische Daten / Technical Data

Isolierkörper	Thermoplastischer Kunststoff, nach UL94 V-0
Insulator	Thermoplastic, rated UL94 V-0
Kontaktmaterial	Kontakte Phosphorbronze; Stifte CuZn
Contact Material	Phosphor bronze contacts; CuZn square pins
Kontaktoberfläche	Lt. Oberflächenoptionen, über Ni (1,3 ... 2,5µm)
Contact Surface	Acc. to options (see below), over Ni (1,3 ... 2,5µm)
Aderquerschnitt	AWG 20 ... 24
Applicable wire Gauge	AWG 20 ... 24
Lötbarkeit	IEC512-12A
Solderability	IEC512-12A
Durchgangswiderstand	< 20mΩ
Contact Resistance	< 20mΩ
Isolationswiderstand	> 1GΩ
Insulation Resistance	> 1GΩ
Spannungsfestigkeit	1500V _{AC/DC} max.
Test Voltage	1500V _{AC/DC} max.
Nennstrom	5A
Current Rating	5A
Temperaturbereich	-25°C ... +85°C
Temperature Range	-25°C ... +85°C
Verarbeitung	Wellenlötverfahren; weitere Informationen in Kapitel T
Processing	Wave soldering, detailed information in ch. T

Friction Lock Hea

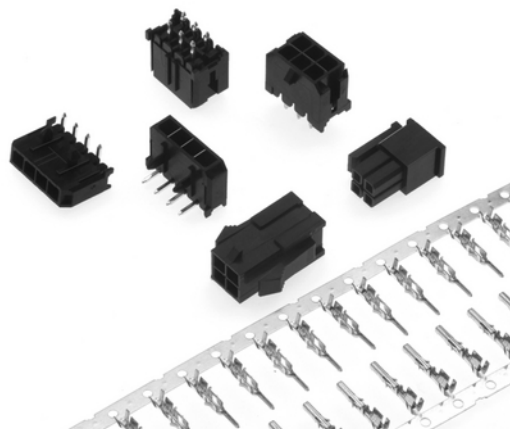

© W+P PRODUCTS

Type: -2-

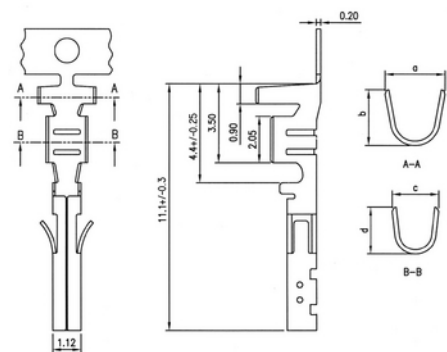

Type: -6-

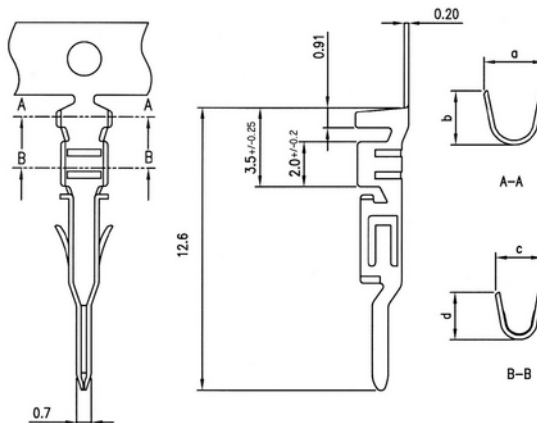

a=2.70+/-0.20mm; b=2.50mm; c=2.10mm; d=2.10mm

Series

583

Kontakte
Contacts

Contacts

01

Type*

2

2 Buchsenkontakt
Female terminal
6 Stiftkontakt
Male terminal

Plating

50

50 Verzinkt
Tin plated

583

Crimp-Rast-Stift-/Buchsenleisten gerade gewinkelt 1-/2-reihig RM 3,00mm

Friction Lock Header and Crimp Housing 3,00mm Pitch

Type / Rows: -1-1

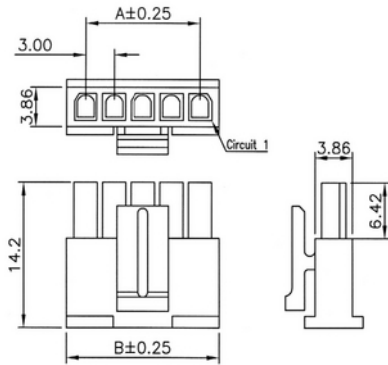

Type / Rows: -5-1

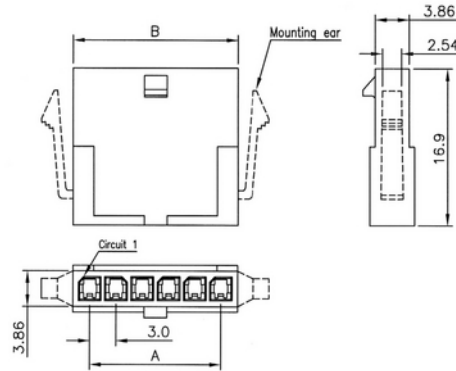

$A=(n-1) \times 3.00\text{mm}$; $B=n \times 3.00 + 1.00\text{mm}$

Type / Rows: -1-2

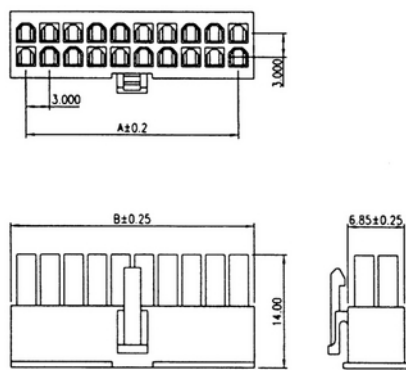

Type / Rows: -5-2

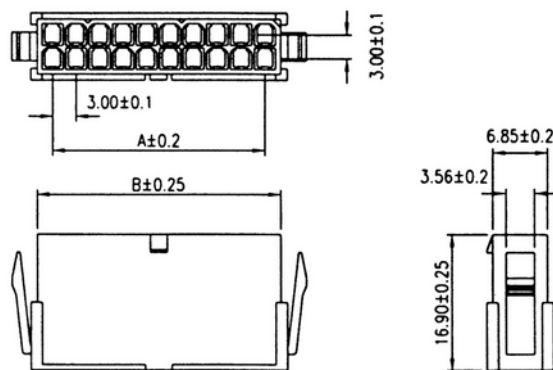

$A=(n/2-1) \times 3.00\text{mm}$; $B=n/2 \times 3.00 + 1.00\text{mm}$

Series

583

Buchsengehäuse
Housings

Contacts*

04

02-12 Einreihig
Single row
02-24 Zweireihig
Double row

Type*

1

1 Buchsengehäuse
Female housing
5 Steckergehäuse
Male housing

Rows*

2

1 Einreihig
Single row
2 Zweireihig
Double row

Crimp-Rast-Stift-/Buchsenleisten gerade gewinkelt 1-/2-reihig RM 3,00mm

Type / Rows: -3-1

Type / Rows: **Friction Lock Header and Crimp Housing 3,00mm Pitch**

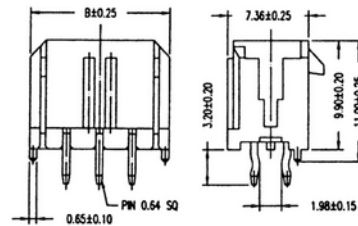
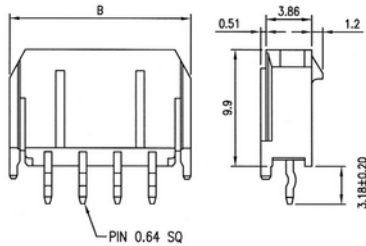
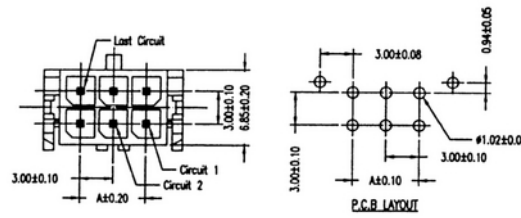
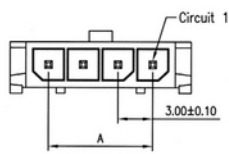

Type / Rows: -4-1

Type / Rows: -4-2

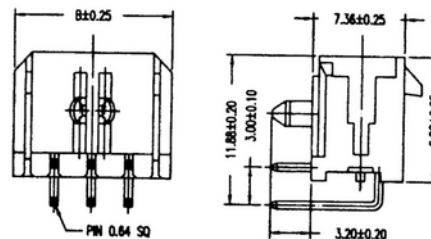
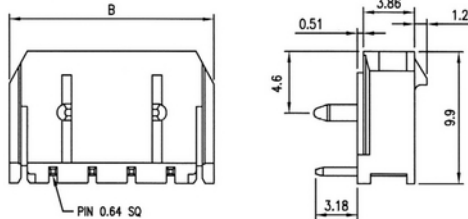
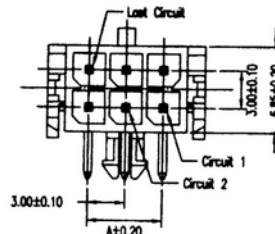
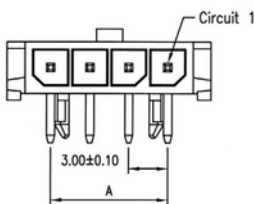

A=n-1 x 3.00mm; B=n x 3.00 + 3.00mm

A=n/2-1 x 3.00mm; B=n/2 x 3.00 + 3.65mm

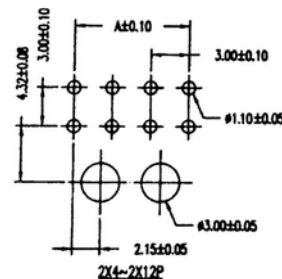
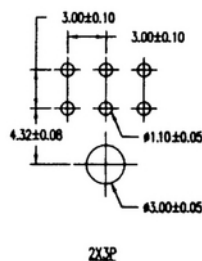
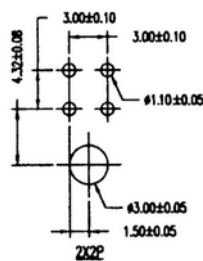
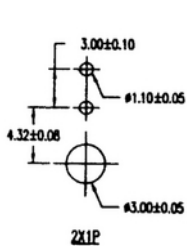

Series

583

Stiftleisten
Pin Headers

Contacts*

04

02-12 Einreihig
Single row
02-24 Zweireihig
Double row

Type*

3

3 Stiftleiste gerade
Straight pin header
4 Stiftleiste gewinkelt
Right-angled pin header

Rows*

2

1 Einreihig
Single row
2 Zweireihig
Double row

Plating

50

50 Verzinkt
Tin plated

* Dies ist ein **Bestellbeispiel** - bitte durch Ihre Spezifikationen ersetzen.
* This is an **order example** - please replace by your specifications.

Informationen zum Wellen-Lötverfahren

Wave-Soldering Information

Empfehlungen für das Wellenlötverfahren

Recommendations for Wave Soldering

Die Bauteile sollten bei einer Lötbad-Temperatur von 260°C in max. 5 Sekunden verlötet werden.
Items should be soldered at 260°C solder temperature in max. 5 seconds.

Empfohlenes Wellenlötprofil:
Recommended wave soldering profile:

