

SMT Taster - schmale Bauform SMT Tact Switch - Slim Body

Technische Daten / Technical Data

Gehäuse/Abdeckung/Hebel	Thermoplastischer Kunststoff, nach UL94 V-0 Rostfreier Stahl Thermoplastischer Kunststoff, nach UL94 V-0
Case/Cover/Actuator	Thermoplastic, rated UL94 V-0 Stainless Steel Thermoplastic, rated UL94 V-0
Kontaktbelastbarkeit	50mA, 12V _{DC}
Contact Rating	50mA, 12V _{DC}
Durchgangswiderstand	< 100mΩ
Contact Resistance	< 100mΩ
Isolationswiderstand	> 100MΩ @ 500V _{DC}
Insulation Resistance	> 100MΩ @ 500V _{DC}
Spannungsfestigkeit	250V _{AC} @ 1min
Test Voltage	250V _{AC} @ 1min
Temperaturbereich	-25°C ... +70°C
Temperature Range	-25°C ... +70°C
Elektrische Lebensdauer	50.000 Zyklen (Type 30, 50) 30.000 Zyklen (Type 40, 60)
Electrical Life	50,000 cycles (Type 30, 50) 30,000 cycles (Type 40, 60)
Verarbeitung	Wellenlötverfahren
Processing	Wave soldering

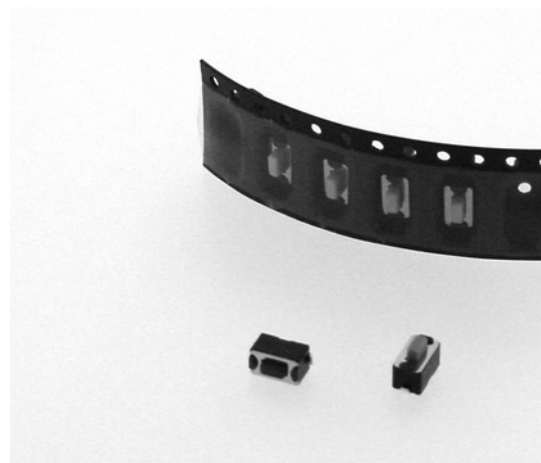

© W+P PRODUCTS

Max. Tasterbelastung: 3kg vertikal für 15s
Max. Switching Force: 3kg vertically for 15s

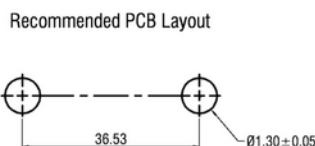
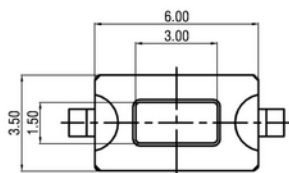

Circuit Diagram

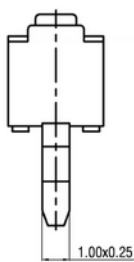
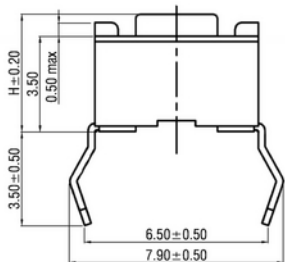

Series	Type	Height*	Op. Force*	Packing*
508	1	1	40	00
	1 Einlöt Through-Hole	1 H=4.3mm 2 H=5.0mm	30 160g±50 (braun) 160g±50 (brown) 40 260g±50 (rot) 260g±50 (red) 50 320g±80 (lachsfarben) 320g±80 (salmon) 70 520g±130 (gelb) 520g±130 (yellow)	ST

508

SMT Taster - schmale Bauform

SMT Tact Switch - Slim Body

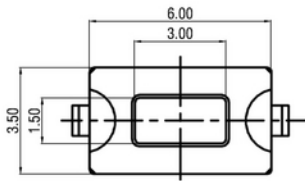

Recommended PCB Layout

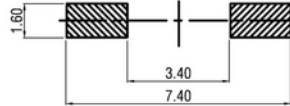

Circuit Diagram

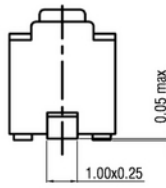
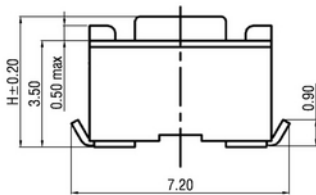

Circuit Diagram

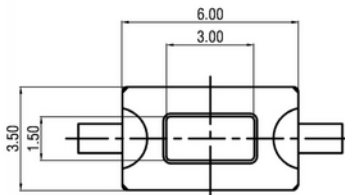

Recommended PCB Layout

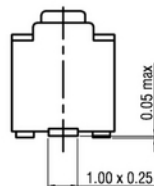
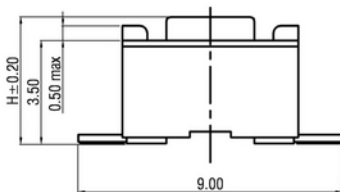
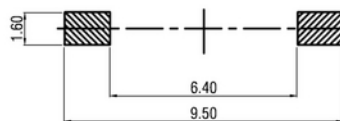

Series

508

Type*

2

2 SMT (mit reduziertem Platzbedarf)
SMT (Reduced Space)
3 Standard SMT
Standard SMT

Height*

1

1 H=4.3mm
2 H=5.0mm

Op. Force*

40

30 160g±50 (braun)
160g±50 (brown)
40 260g±50 (rot)
260g±50 (red)
50 320g±80 (lachsfarben)
320g±80 (salmon)
70 520g±130 (gelb)
520g±130 (yellow)

Packing*

00

ST
TR

* Dies ist ein **Bestellbeispiel** - bitte durch Ihre Spezifikationen ersetzen.
* This is an **order example** - please replace by your specifications.

Lieferformen / Packing Options:

- ST In Stangen / In tubes
- ST In Stange / In tubes
- TR Tape & Reel Verpackung / Tape & Reel Packing

Informationen zum Wellen-Lötverfahren

Wave-Soldering Information

Empfehlungen für das Wellenlötverfahren

Recommendations for Wave Soldering

Die Bauteile sollten bei einer Lötbad-Temperatur von 260°C in max. 5 Sekunden verlötet werden.
Items should be soldered at 260°C solder temperature in max. 5 seconds.

Empfohlenes Wellenlötprofil:
Recommended wave soldering profile:

